



MOBeduc

2017



THE LOCKER CATALOGUE



WWW.MOBEDUC.COM



MOBeduc

MOBEDUC produces the best product on the market for nursery and primary school. But our philosophy goes far beyond this idea, our philosophy is reflected in everything we do: for us primary education is our challenge and we must protect and care for it.

Mobeduc is a furniture manufacturer, both standard and custom-made, with fundamental values such as **QUALITY**, **SERVICE** and **DESIGN**.

QUALITY: All materials used for the manufacture of furniture have been tested for strength and safety by TECNALIA. Quality is not only ensured by this certification, but it is all managed by a quality management system as certified by **UNE- EN ISO 9001**.



SERVICE: For us the **pre-sale**, **sale** and **after-sales services** are the bases of our company. A continued communication with the clients that make us a reference in our sector. Our management, commercial and technical teams are fully integrated and in continuous contact with the client to facilitate their work.

DESIGN: Mobeduc is a manufacturer of school furniture, adapting to the needs and ideas of customers. Our extensive experience in the development and manufacture of custom furniture makes the design, functionality and finish of the furniture go beyond the expectations of the final customer.

Mobeduc is also a company committed to sustainable development, and environmental protection; as demonstrated by the **UNE-EN ISO 14001** "Environmental Management System", which ensures the minimum environmental impact, reduction of energy and raw material consumption, improvement of waste management derived from production process and the optimization of the company management.



LOCKER CATALOG INDEX

1. EXPLANATION: LOCKER CATALOG _____ PÁG 4
2. DESIGN PROPOSAL _____ PÁG 5
 - 2.1. 3D design _____ PÁG 5
 - 2.2. Materials _____ PÁG 6
 - 2.3. Keys and doors _____ PÁG 7
 - 2.4. Legs and hangers _____ PÁG 8
3. ASK FOR QUOTE _____ PÁG 9
4. MANUFACTURING AND QUALITY _____ PÁG 9



MOBeduc

1. EXPLANATION: LOCKER CATALOG

¿Why this catalog?

At Mobeduc we offer our customers a broad range of sizes, colors, keys and locker designs for each school, for every need. With your idea and our knowledge, we will achieve the PERFECT LOCKER.

Design and development process

Our commitment is to facilitate and save the budget of certain lockers for each client.

The process goes through the following steps:

Client design suggestion

Choice of the different components of the lockers, such as measures, materials, type of keys, type of legs, number and type of doors, hangers...

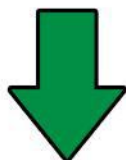

3D design



Budget



Manufacturing and shipping

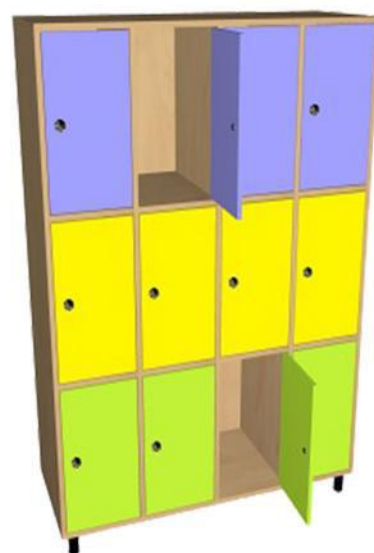

2. DESIGN PROPOSAL

Before we start designing you should make the proper decisions about measurements and the number of doors.

Measurements:

- Stay or room measures
- Locker set measures
- Individual lockers measures

Number of doors:

- Doors by locker
- Total number of doors

In case of not being clear the distribution of the room can also be structured through 3D DESIGN.

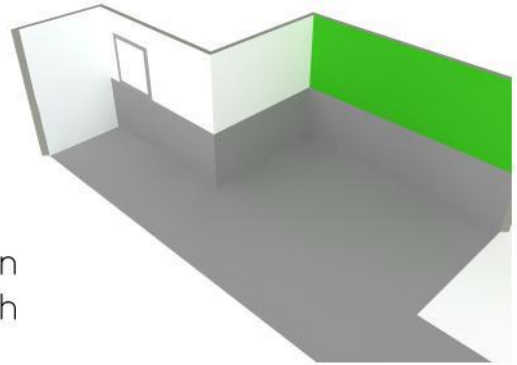

2.1. Locker 3D design

Through this effective tool of work you will be able to observe infinity of designs adapted to spaces.

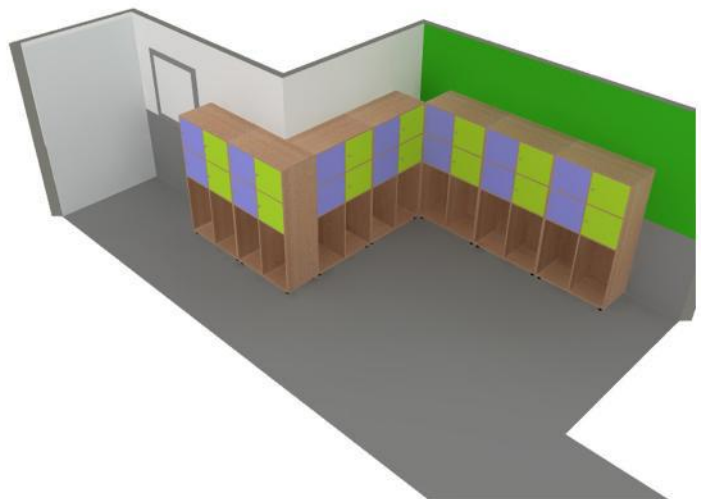
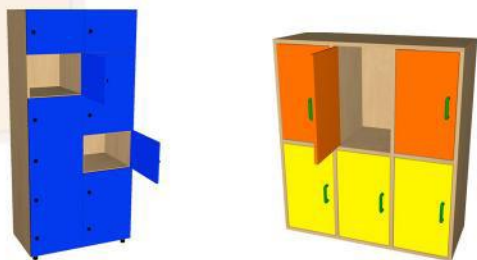

2.2. Materials

Structure materials

Melamine particle board 19mm



*Check for other colors

Edged with PVC of 2mm in the same color of the structure.

Doors materials

Melamine particle board 19mm

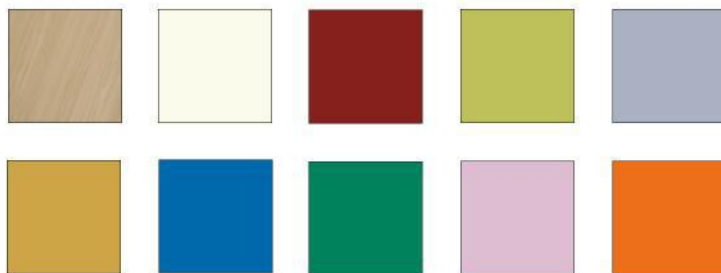

*Check for other colors

Edged with PVC of 2mm in the same color of the structure.

Compacmel 13mm (HUMIDITY HIGH RESISTANCE)



*Check for other colors

Edges with rounded black finish.

For greater security and firmness, the doors of COMPACMEL will be fastened by Piano Hinges.



2.3. Keys

A wide range of keys reach of customers to achieve the desired finish and functionality.



**Standard key
UNEQUAL**

(includes master key)



4 wheel key

(includes master key)



Padlock key



Currency key

(includes master key)

2.3. Legs and hangers

LEGS

Available to save possible small slopes of the ground, skirting boards, half reeds...



Adjustable legs
35-50 mm



Adjustable legs
65-100 mm



Adjustable legs
150 mm



Possibility of installing with plinth at any height.

HANGERS

Lineal hangers:



RED



BLUE



YELLOW



GREEN



"TRIO"



BAR HANGER

Swivel:

Bar:

3. ASK FOR QUOTE

We will make a budget with the designs and materials chosen, that later can be modified adjusting to the customer needs. We have full experience in project management.

4. MANUFACTURING AND QUALITY

After the acceptance of the budget we will start with the order guaranteeing and testing the product throughout the production process.

Our design, optimization, numerical control programs and our technical department will work to adapt the design to all the chosen materials.

The process of testing, production and quality makes the finish of the final product, as expected by our technical department.





MOBeduc

ADDRESS

Vía Romana, s/n
31520 CASCANTE (NAVARRA) SPAIN

PHONE

+34 948 85 03 84
+34 948 85 03 97

FAX

+34 948 85 03 97

E-MAIL

export@mobeduc.com
pedidos@mobeduc.com

WEB

www.mobeduc.com

